

Instruction Manual TVH

MANUAL HYDRAULIC TEST STAND

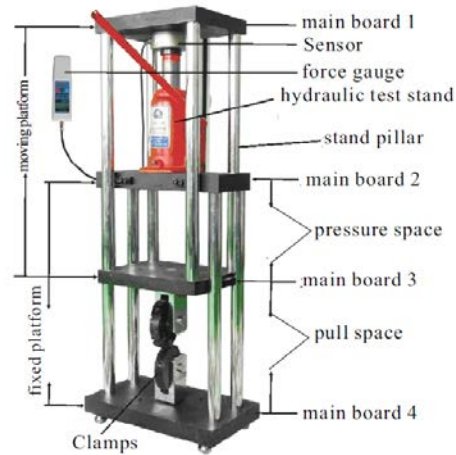

Remark: Clamps, force gauge, sensor and hydraulic are optional parts!

Assembly: The main board 1 and the main board 3 have to be connected by moving the stand pillar to the right position and then main board 2 and 4 have to be connected to fix the test stand. These two test stands can cross up and down. After that, power supply and measurement set (hydraulic press, sensor and digital force gauge) have to be installed between the moving test stand's upper board and the upper board has to be fixed. A loading space for the test object has to be formed on the upper plane of the fixed test stand's upper board. In the second working space below two correlative clamps have to be collocated for testing different kinds of objects.

Working principle

This test stand transforms the hydraulic energy of the manual hydraulic test stand to mechanical energy by driving board 1 up. So, the whole test stand is pushed up. If the space between board 3 and 2 and 4 is changed, there can be achieved tensile, compressive and other mechanical tests for the object located in the second working platform. This test stand uses the unidirectional load to achieve draw and press (bidirectional) tests.

Specification

Model:	TVH 500K
Dimensions:	520mm x 368mm x 1460mm
Capacity:	500 kN
Test Travel:	180 mm
Testing space (no fitting clamps):	Compressive 312 Tensile 408

Installation methods

1. The test stand has to be placed on the floor and it has to be levelled. It has to be installed, if required, with the optional equipment. Using the screw of the baseboard, the test stand can be better fixed. Please also refer to the

General Introduction

Thank you for buying this SAUTER hydraulic Test Stand. We hope you are pleased with your high quality product with and its functional range.

This Test Stand takes manual hydraulic press as drive to achieve the tested material's tensile, yield and correlation mechanics. The structure is simple, safe and the result is reliable. There are also no special requirements to the operating person. Other clamps can be collocated to perform tests on different objects.

This hydraulic Test Stand is widely applied in architecture, metal industry, dynamic mechanisms, compression and fracture tests.

If you have any queries, wishes or helpful suggestions, do not hesitate to call our service number.

Specifications

Instruction Manual TVH

installation dimensions because this stand needs much space and it is high.

2. Sensor installation: The collocated parts of the test stand have to be used to assemble it as shown in the following diagram. The sensor, test stand, and the hydraulic tests stand have to be placed in the centre.

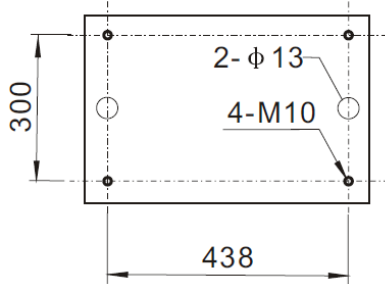

Bottom angle bolt installation

Installation diagram TVH 500K

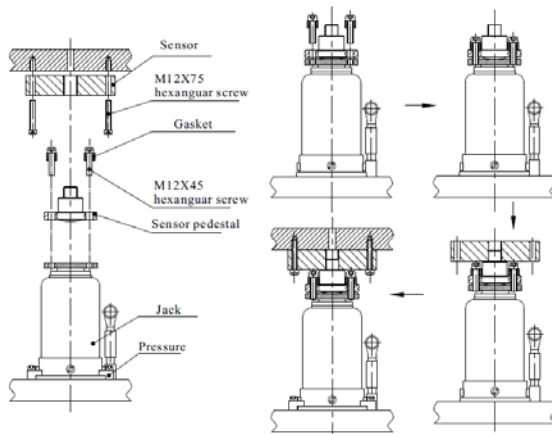

Operation

This test stand can test in tensile direction compressive direction and bidirectional. It has to be installed in a suitable position in accordance with the sample requirements. The jack has to be used to achieve high strength and a large testing load. Do not apply damaged or warped clamps. They might fall away or crush. Please be careful in order to prevent any accidents!

The test stand may not be applied beyond the given range of the push/pull gauge sensor's rated load. If the sensor would be damaged, this would also result in an accident.

Daily Maintenance

1. Before using the instrument, it has to be assured that all parts of the test stand are fixed the right way.
2. It may not be applied beyond its capacity, the rated load is 500 kN.
3. It has to be maintained daily, which means that all parts of the test stand have to be kept clean.
4. If there should occur a malfunction, please contact our service number as soon as possible. Please do not

disassemble any parts or try to repair it yourself without the consent and instruction of SAUTER GmbH.

Packing List

Description	Quantity
SPV-500K Manual Hydraulic Test Stand	1
50 ton jack (with handle)	1
Test Stand Y type Clamps	2
Jack connector (collocate as force gauge's specification	1
M12 x 75 Screw	4
M8 x 60 Screw	4
Pressure Block	4
Rubber Gasket	3
Instruction Manual	1
Qualification Certification	1
M12 x 45 Screw	3

CE Declaration of Conformity



SAUTER GmbH
D-72336 Balingen
E-Mail: info@sauter.eu
Tel: 0049-[0]7433-9933-0
Fax: 0049-[0]7433-9933-149
Internet: www.sauter.eu

Konformitätserklärung

Declaration of conformity for apparatus with CE mark
Konformitätserklärung für Geräte mit CE-Zeichen
Déclaration de conformité pour appareils portant la marque CE
Declaración de conformidad para aparatos con marca CE
Dichiarazione di conformità per apparecchi contrassegnati con la marcatura CE

English We hereby declare that the product to which this declaration refers conforms to the following standards.
Deutsch Wir erklären hiermit, dass das Produkt, auf das sich diese Erklärung bezieht, mit den nachstehenden Normen übereinstimmt.
Français Nous déclarons avec cela responsabilité que le produit, auquel se rapporte la présente déclaration, est conforme aux normes citées ci-après.
Español Manifestamos en la presente que el producto al que se refiere esta declaración está de acuerdo con las normas siguientes
Italiano Dichiariamo con ciò che il prodotto al quale la presente dichiarazione si riferisce è conforme alle norme di seguito citate.

TEST STAND: SAUTER TVH

Mark applied	EU Directives	Standards
CE	89/336/EEC ; 90/31/EC 93/68/EEC ; 2004/109/EC	EN 61326-1:2006

Date: 07.11.2011

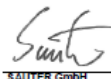
Signature: 
SAUTER GmbH
Management

SAUTER GmbH, Ziegler 1, 72336 Balingen, Tel: +49 (0) 7433 99330, Fax: +49 (0) 7433 9933149